



If you have questions or need assistance, please call us at (425) 493-1939 and ask for the sales help desk. We are available to answer questions and walk you through the worksheet.

CUSTOMER INFORMATION

Name: \_\_\_\_\_
Job Site Address: \_\_\_\_\_ City: \_\_\_\_\_ State: \_\_\_\_\_ Zip: \_\_\_\_\_
Daytime Phone: \_\_\_\_\_ Job Site Phone: \_\_\_\_\_ Fax Number: \_\_\_\_\_
E-mail: \_\_\_\_\_
Mailing Address (if different): \_\_\_\_\_

PROJECT INFORMATION

KITCHEN [ ] Countertops [ ] Island [ ] Eating Bar [ ] Desk
BATH [ ] Vanity [ ] Shower Surround [ ] Tub Surround [ ] Tub Deck

COLOR

Color Selection: \_\_\_\_\_
Color Selection: \_\_\_\_\_
Color Selection: \_\_\_\_\_

BACKSPLASH

Splash Height: [ ] 4" (Standard) [ ] 18" (Full Height) [ ] Other: \_\_\_\_\_

EDGE (Circle edge profile below)

Quarter Bevel Full Bullnose Half Bullnose Eased
Half Bevel Quarter Round Top and Bottom Quarter Round Ogee

SINK

[ ] Drop-In Top Mount (customer supplied) [ ] Undermount (customer supplied) [ ] Undermount Eclipse Stainless (supplied by see website)



**CUSTOMER INFORMATION**

- Freestanding Range  
(no counter or splash behind)
- Slide-in  
(counter and splash behind)
- Cooktop  
(drop in)
- None

**COUNTERTOP REMOVAL**

Would you like ProGranite to remove your existing countertops?

- Yes, Tile     Yes, Laminate     Yes, Other \_\_\_\_\_     No     Does Not Apply (new cabinets)

SKETCH THE LAYOUT OF YOUR COUNTERTOPS

- Show backsplash location. (double line denotes backsplash)
- Show which edges need to have a decorative profile. (mark edges with circle)
- Show approximate location of appliances and sinks.
- Include perimeter dimensions.
- Give overall dimensions of countertops on islands and peninsulas.
- If you have a cabinet plan, please include.

EXAMPLE

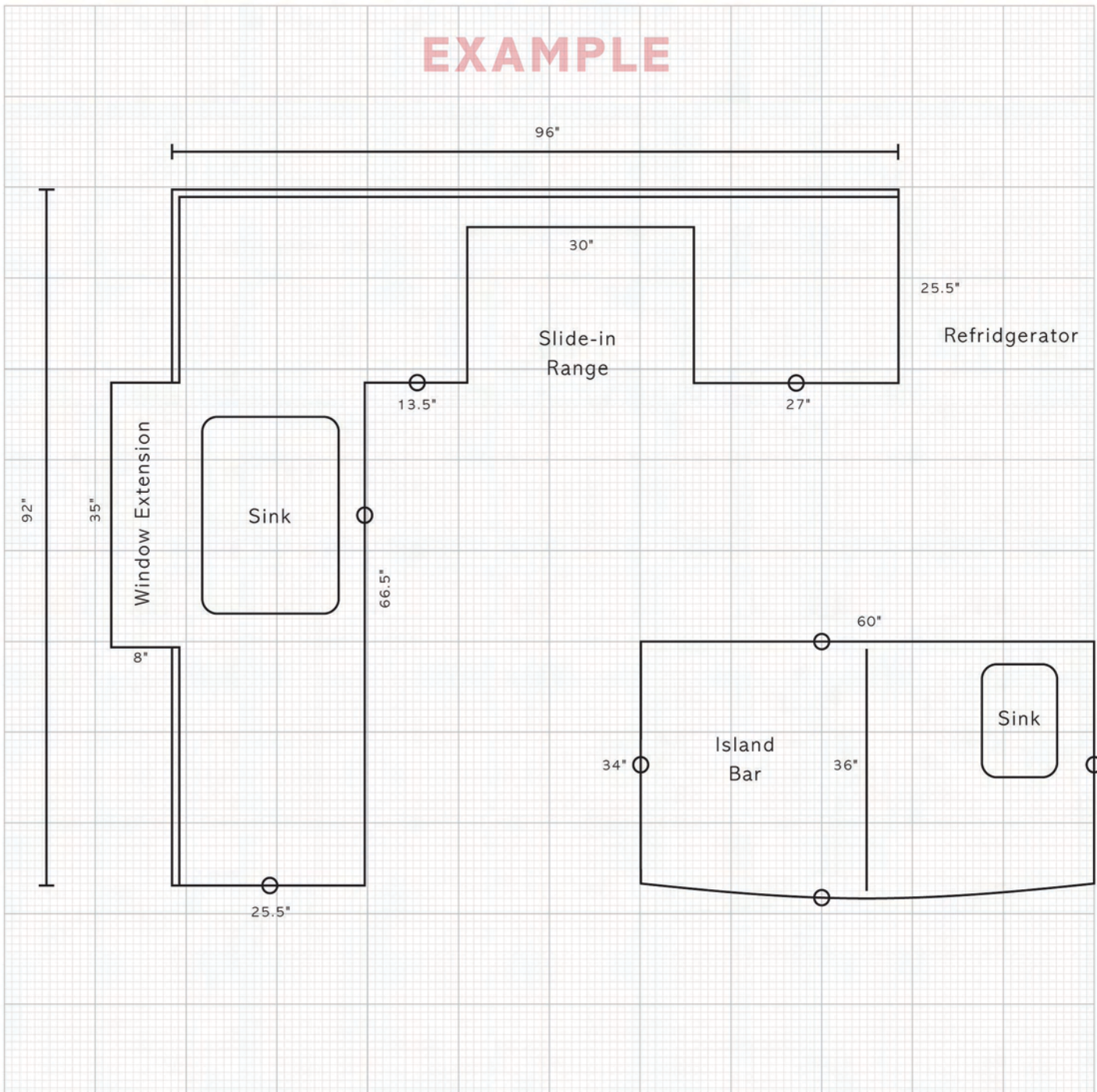



SKETCH THE LAYOUT OF YOUR COUNTERTOPS

- Show backsplash location. (double line denotes backsplash)
- Show which edges need to have a decorative profile. (mark edges with circle)
- Show approximate location of appliances and sinks.
- Include perimeter dimensions.
- Give overall dimensions of countertops on islands and peninsulas.
- If you have a cabinet plan, please include.

A large, empty grid area for sketching countertop layouts. The grid consists of 10 columns and 15 rows of squares, providing a space for drawing and measuring countertop designs.